

DRAWING 1: PRE-MILLED PARTS

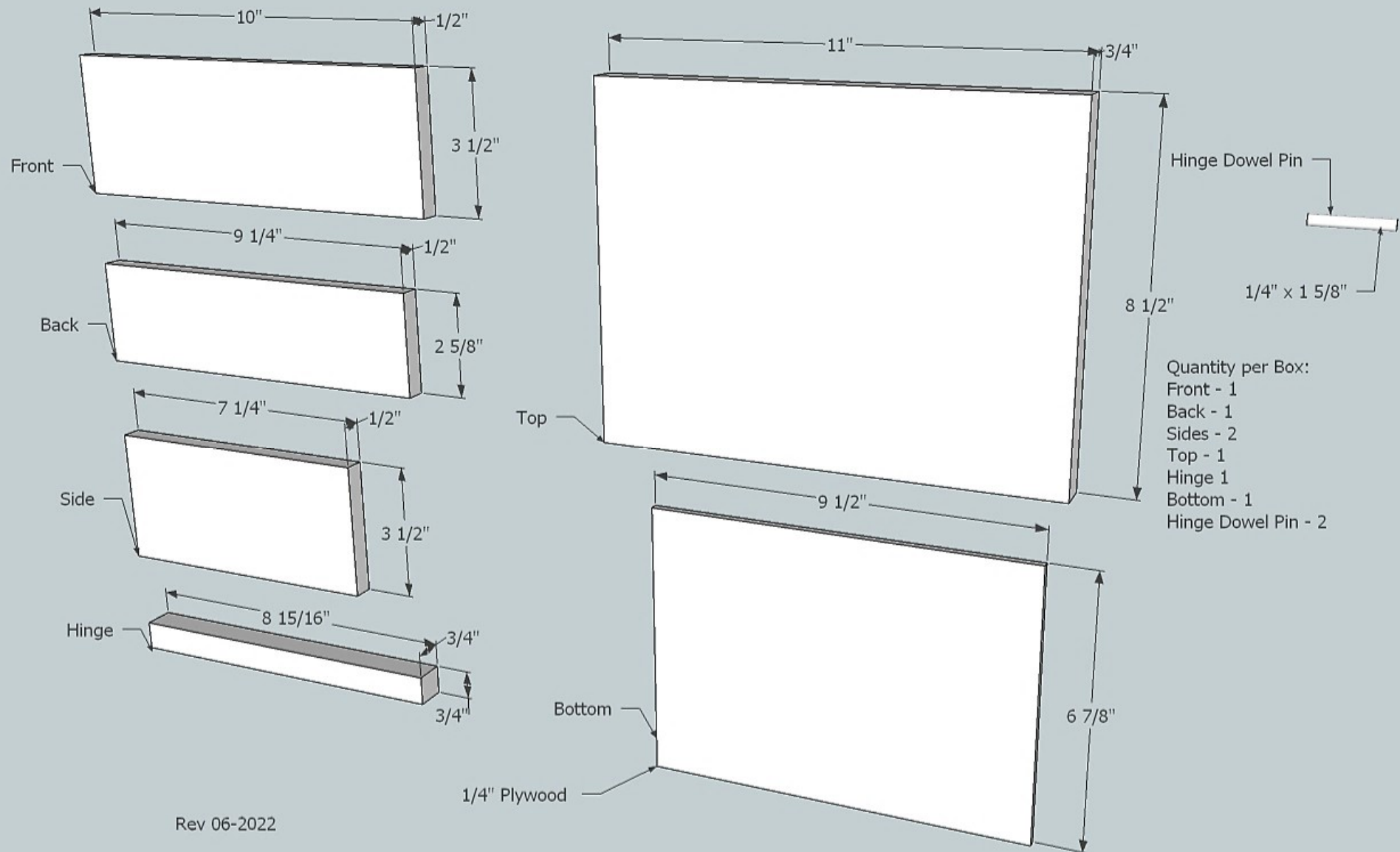

DRAWING 2: FRONT

Pre-Milled Front

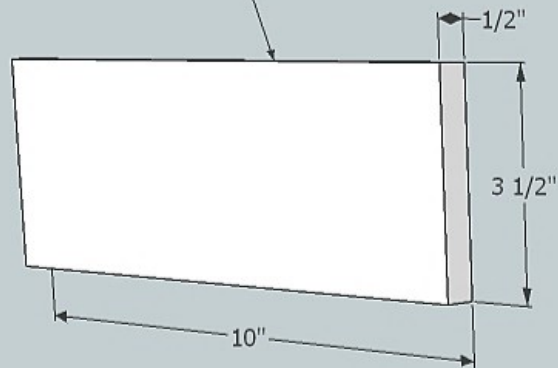

- Step 1: Mill a 3/16" round-over on all edges and corners

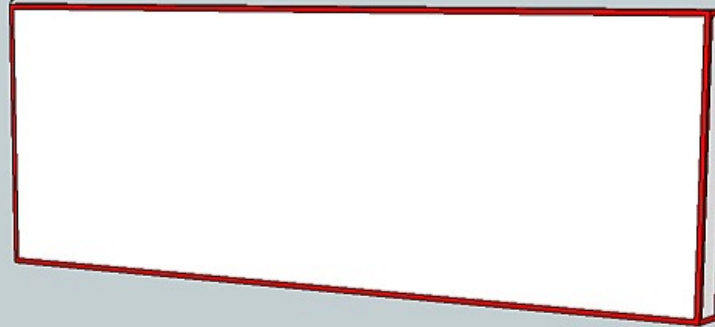

- Step 2: Mill rabbets 1/2" by 1/4" deep (Note 1)

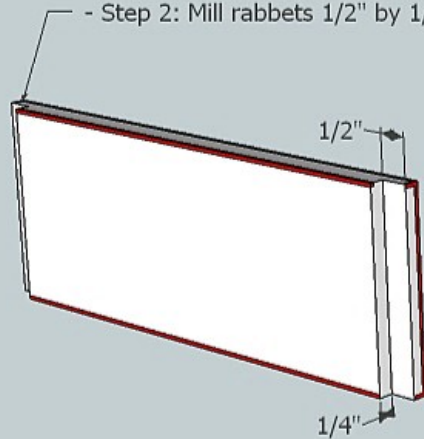

- Step 3: Mill a 1/4" x 1/4" deep groove starting 3/16" from the bottom edge

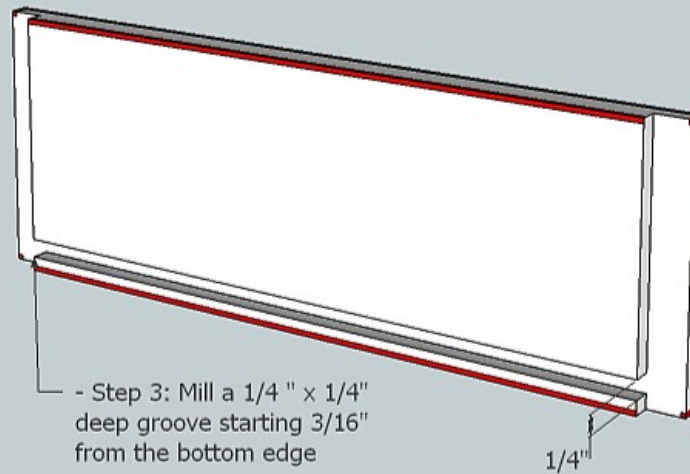

Note1:
The 1/2" dimension should be adjusted to equal the thickness of the Sides

DRAWING 3: BACK

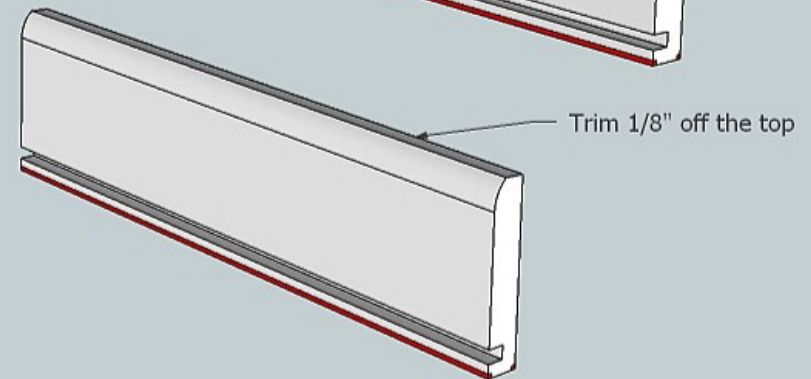
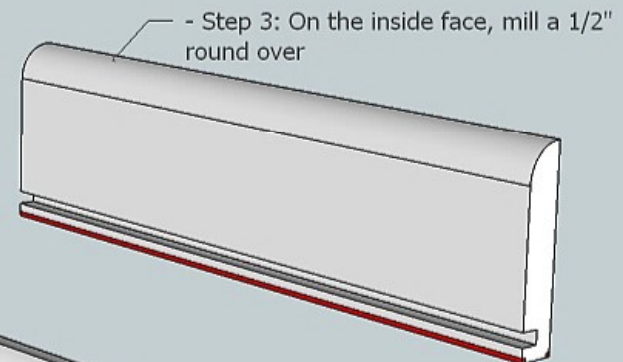
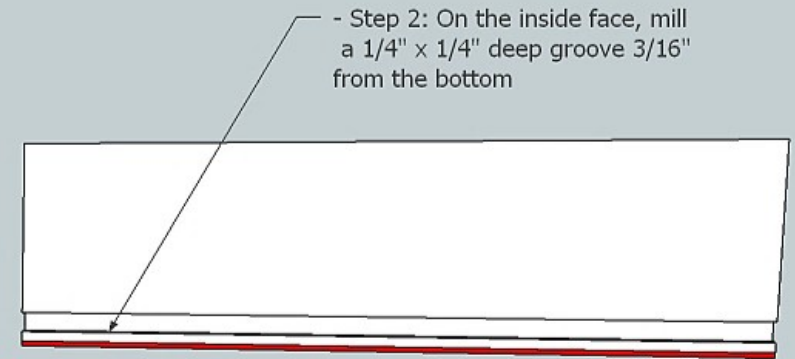
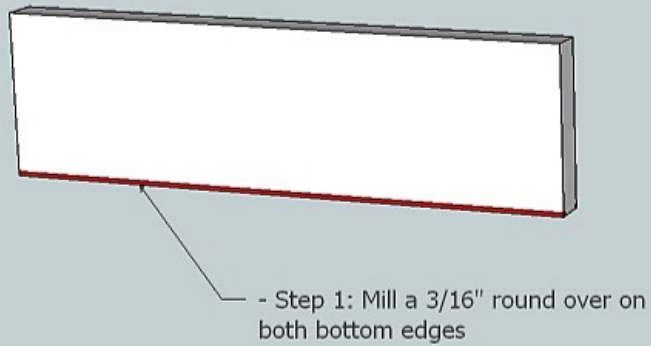
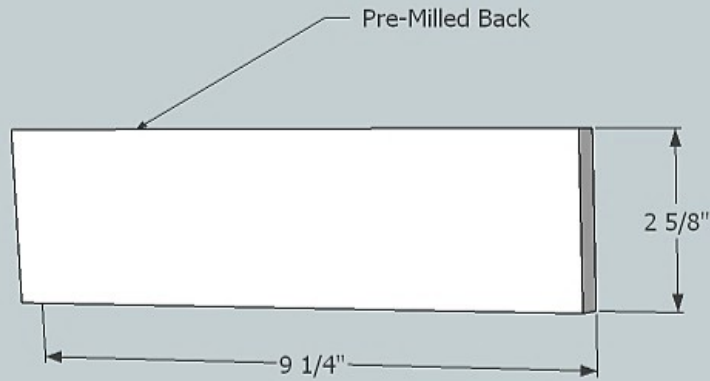

DRAWING 4A: SIDES

Note: The two sides are mirror images of each other

Pre-Milled Side

3 1/2"

7 1/4"

Left Side

2 3/4"

1/2"

- Step 1: On the inside face, use a 3/4" straight router bit to mill a 1/2" rabbet, 1/8" deep in the rear of both Sides. (Note 1)

- Step 2: Round over the top back corner of both sides with a 3/4" round over bit

Note1:
The 1/2" dimension should be adjusted to equal the thickness of the Back

Right Side

DRAWING 4B: SIDES

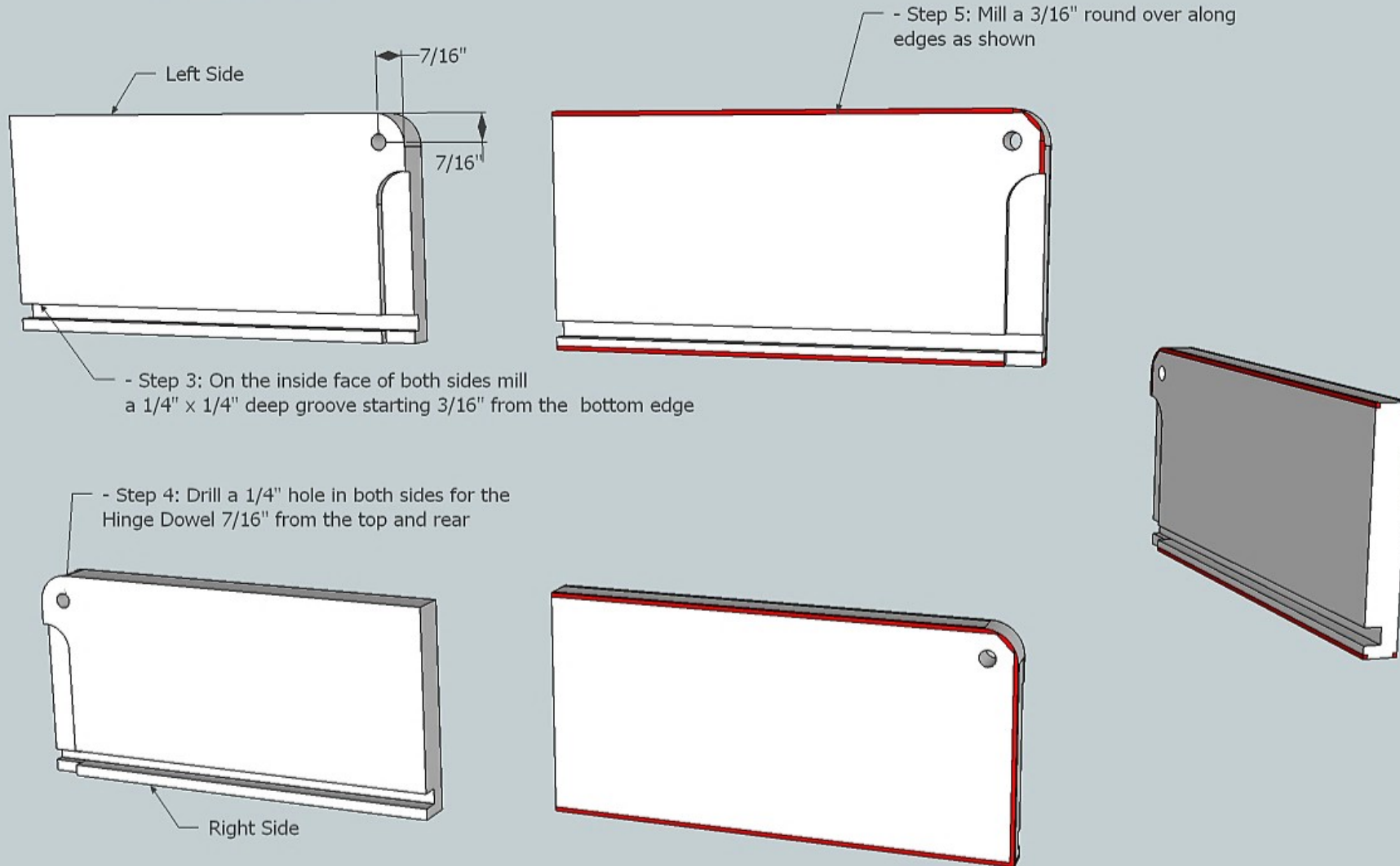

Rev 06-2022

DRAWING 5: BOX ASSEMBLY

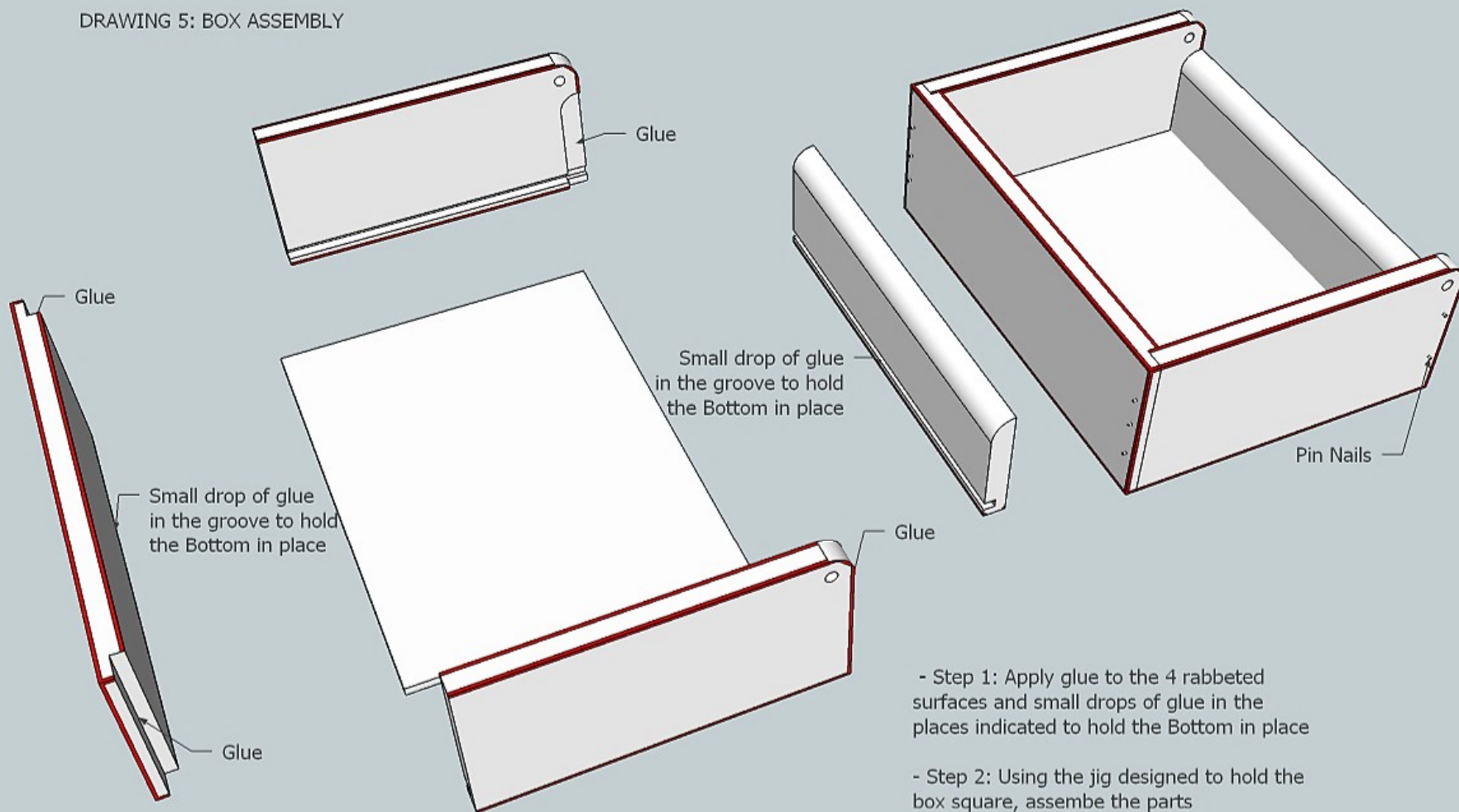

- Step 1: Apply glue to the 4 rabbeted surfaces and small drops of glue in the places indicated to hold the Bottom in place
- Step 2: Using the jig designed to hold the box square, assemble the parts
- Step 3: Fasten with 23 gage pin nails at the places indicated

DRAWING 6: LID & HINGE

